

**Note:**

All substrates are to be suitably prepared and primed as required in accordance with the project specification details, prior to the installation of the Polyroof waterproofing system.

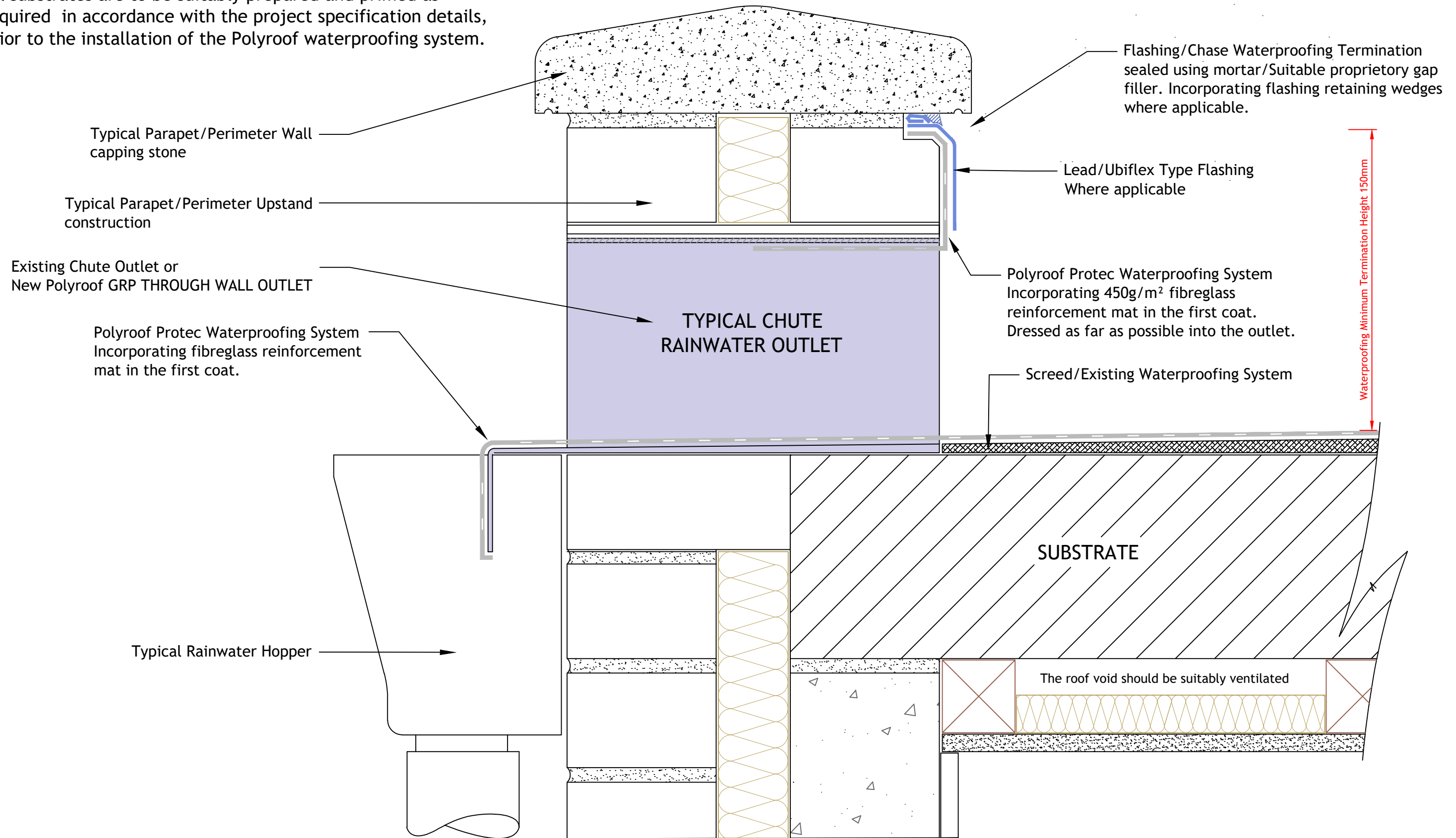

**POLYROOF**  
ADVANCED LIQUID ROOFING

Castle Park Industrial Estate, Evans Street, Flint, CH6 5XA  
T: 01352 735 135 E: admin@polyroof.co.uk W: polyroof.co.uk

DRAWING TITLE : CHUTE DRAIN OUTLET DETAILS

POLYROOF SYSTEM : POLYROOF PROTEC RANGE

SCALE : Drawing not to scale at A3. The purpose of this drawing is for information only, DO NOT SCALE use featured dimensions only.

DRAWING No : PR22-066

DATE : 23-02-2022

DRAWN BY : B.Hill

REVISION No: R-000